

Armidale Place

MONTPELIER

APPROXIMATE FLOOR AREA
535 SQM / 49.7 SQFT



GROUND FLOOR

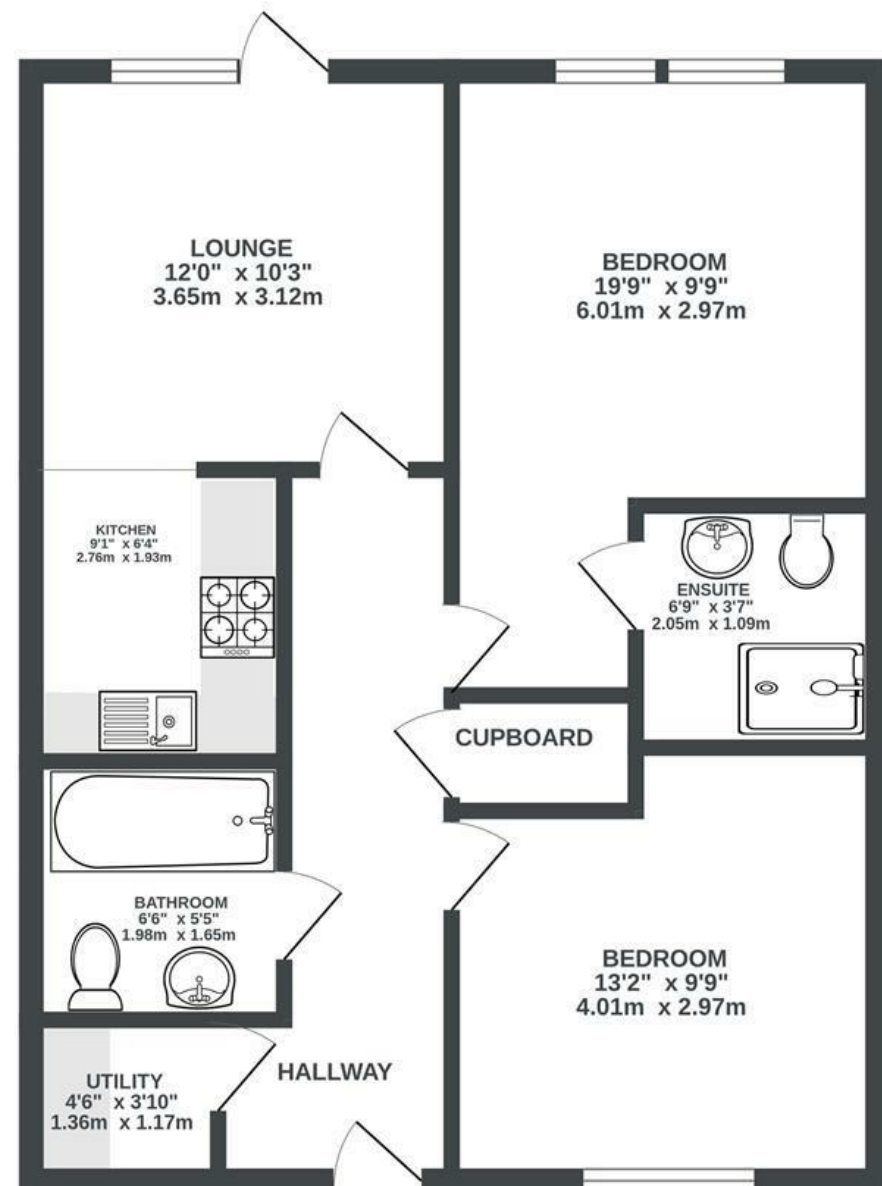

Boardwalk

Armidale Place , BRISTOL

£

£270,000



BS6 5BQ

zzz

2 Bedrooms



2 Bathrooms

"This was my perfect first home– easy, low-maintenance, and cheap on bills. It has bonuses like a utility and parking, but the best feature is the private, sun-trap-in-the-afternoon decking. I bought the flat 8 years ago and lived there with a lodger for 2 years - easily spacious enough with the second bathroom. I then moved in with my partner (just up the road - it really is the best area) and have rented the flat out since to fantastic tenants. It's very rentable and has never been empty. This is my favorite location in Bristol, central, yet the flat itself is peaceful."

